

Durable, Rugged Flooring.

Poultry Flooring & Support Frames

Plastic Slats:

- Our new wear resistant, rugged, polypropylene poultry slat is now available with either the galvanized metal frame, the fiberglass rail support system, or can be used on a wood frame without doubling the joists.
- The slip resistant surface with 1" x 1 5/8" openings cuts cleaning time and will improve your bio-security since it will not harbor bacteria.
- Our unique design works for mounting on rails or nailing to the floor.
- Notice the built in perch rails for bird comfort.
- Unlike wire mesh or wood, there is no need to worry about rot or water absorption.
- VAL-CO slats reduce breast blisters from splinters and leg or foot pad problems.
- White, black or gray colors are available.
- Openings are over 50% of the slat area ensuring feces passing through.



Performance You Can Count On

**The VAL-CO Family
of products provides all
your equipment needs.**

- Watering Systems
- Feed Bins, Fill Systems
 - Feeders
 - Nests
- Egg Collection Systems
 - Cage Equipment
 - Brooders & Heaters
 - Evaporative Cooling
- Fans & Other Ventilation
- Whole House Controllers™
 - Flooring
 - Cremators
 - Alarms

Floor Grid

Our galvanized steel support grid sections are available in 6 feet wide sections that are 12 or 14 feet in length. Wall and curb mount brackets are available.

Floor Rails

We offer either winchable or non-winchable galvanized steel rails for use with our Community Nests in lengths of 3, 6, 9, and 12 feet.

Fiberglass Beams and Beam Support Pads

Heavy Duty fiberglass supports with excellent strength and corrosion resistance are available in various lengths. They are easy to clean and help maintain a bio-secure environment.



Beam weight / ft.
1.2 lbs. / ft.

Above: Beam
Height = 4.48"
Thickness = 0.216"
Base = 1.75"



Above:
Beam Support Pad

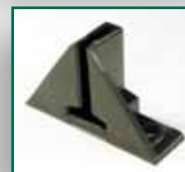

Left:
Beam Support Foot

Installation Instructions

- The core temperature of the slats must be at least 40°F (5°C) when they are installed (i.e. they must be stored in a location prior to installation that is at least 40°F (5°C) for approximately 24 hours).
- During installation the house temperature should remain above 40°F (5°C).
- The slats are made of polypropylene, thus they will expand and contract as the temperature changes. Make sure you take this into account as you install your substructure.
- Poultry flooring is designed to support the weight of chickens. Workers should walk only on supported areas of the flooring.
- If a hard object >10 lbs (4.5 kg) is dropped onto a slat the slat should be replaced (internal damage may have occurred which may or may not be visible).

Call your local VAL-CO representative or distributor for more information on this and other fine quality products.

North America:

Phone: 800-99VALCO (800-998-2526)

Fax: (+1) 419-678-2200

E-mail: sales@val-co.com

International:

Phone: (+1) 419-678-8731

Fax: (+1) 419-678-2200

E-mail: intl.sales@val-co.com



Performance You Can Count On

www.val-co.com