



Quick Sheet Instructions

Boot Safety Switch, Adjustable #730965



The Boot Safety Switch can be used in a variety of feeding applications to prevent the feeding system from running without feed (example feed hopper installation shown).

Installation Instructions

1. Use the #730986 Safety Switch Template to mark the hole locations onto the panel that you want the Boot Safety Switch mounted to. Drill 4 outside holes 9/32" (7.14375 mm) diameter and the center hole at 1/2" (12.7 mm). **(If extra pin travel is required drill center hole 3" (7.63 cm)).** As shown In Figure 2.

Figure 1

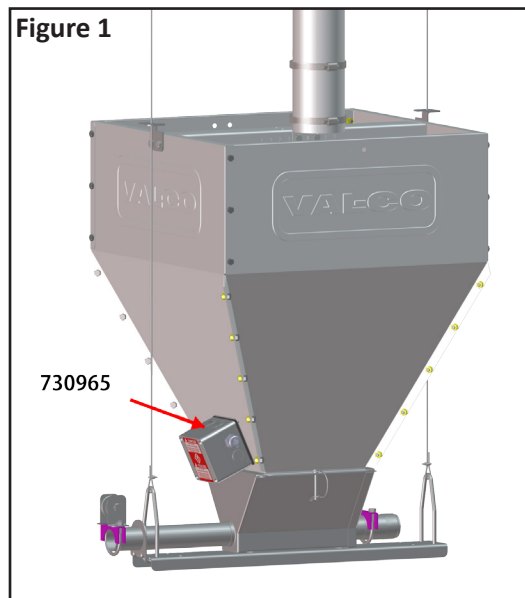
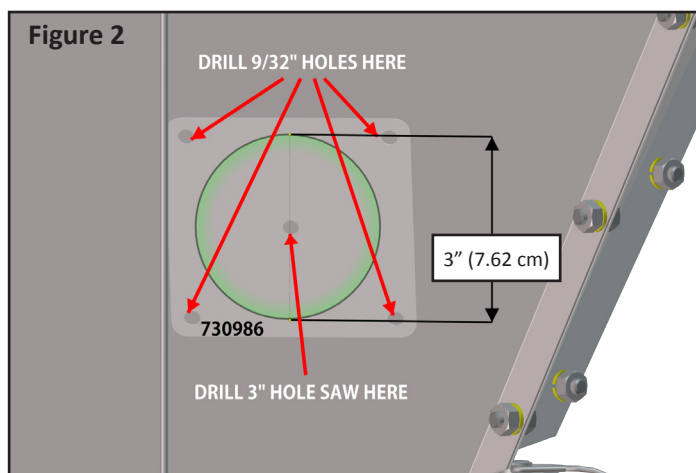
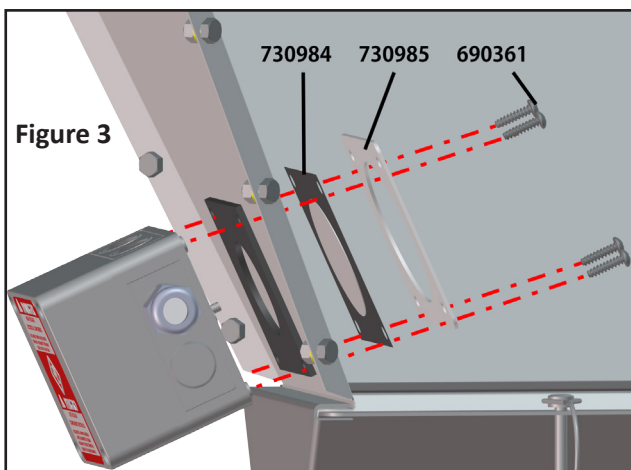

Figure 2



2. Start the 690361 screws, from the inside of the hopper, through the diaphragm retainer, then through the diaphragm, then through the hopper panel, then align the seal and enclosure from the outside, driving each screw into the enclosure and then tighten all 4 screws. (As shown in Figure 3.)



Adjustment

3. Connect the wire to the switch at the Spade Terminals as shown in Figure 4.

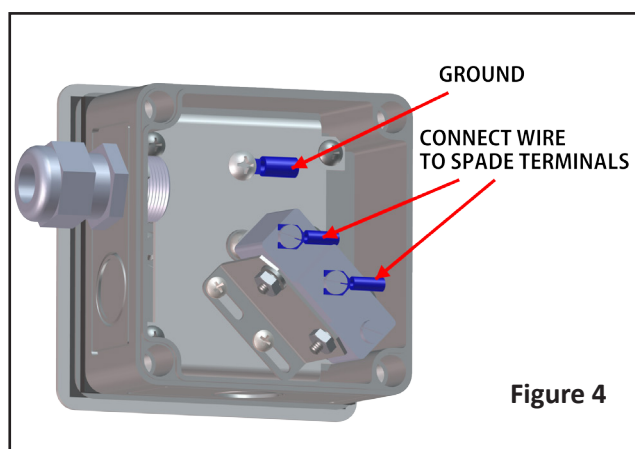

Figure 4

Adjustment - continued

4. Adjust the sensitivity required to activate the switch by loosening the 2 screws and sliding the switch bracket as shown in Figure 5.
5. Set the proper pin travel.
 - a. Loosen the bolts securing the switch to the bracket.
 - b. Rotate the switch towards the pin until the switch activates as shown in Figure 6
 - c. Back the switch off from the pin until it deactivates.
 - d. Secure the bolts.
 - e. Verify the pin travel is correct. Press the diaphragm until the switch is activated, then release the diaphragm.



If the switch does not deactivate, start with step "5.a" again.

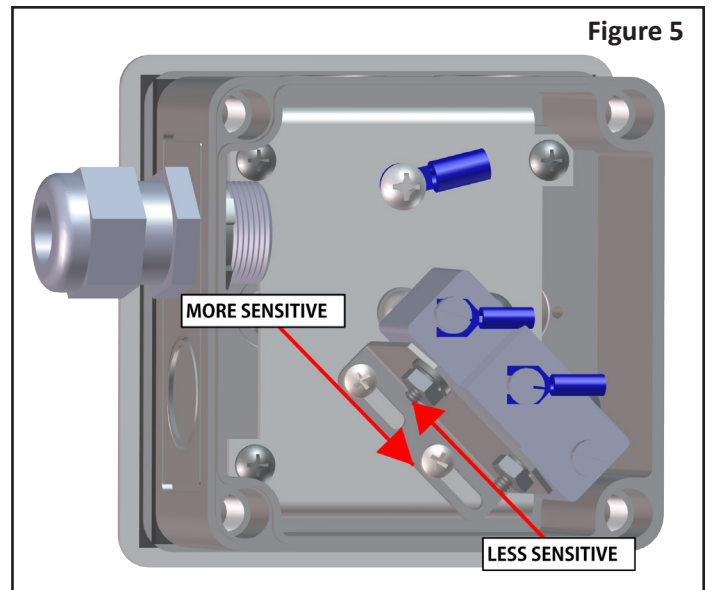

6. Attach enclosure cover and connect electrical power to the switch.
7. Verify the setup switch assembly is functioning properly and make necessary adjustments if required prior to unattended usage.

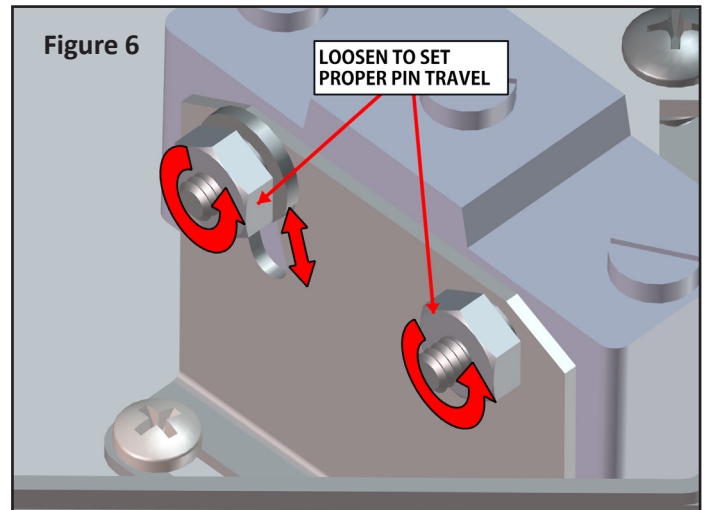

Wiring Diagram

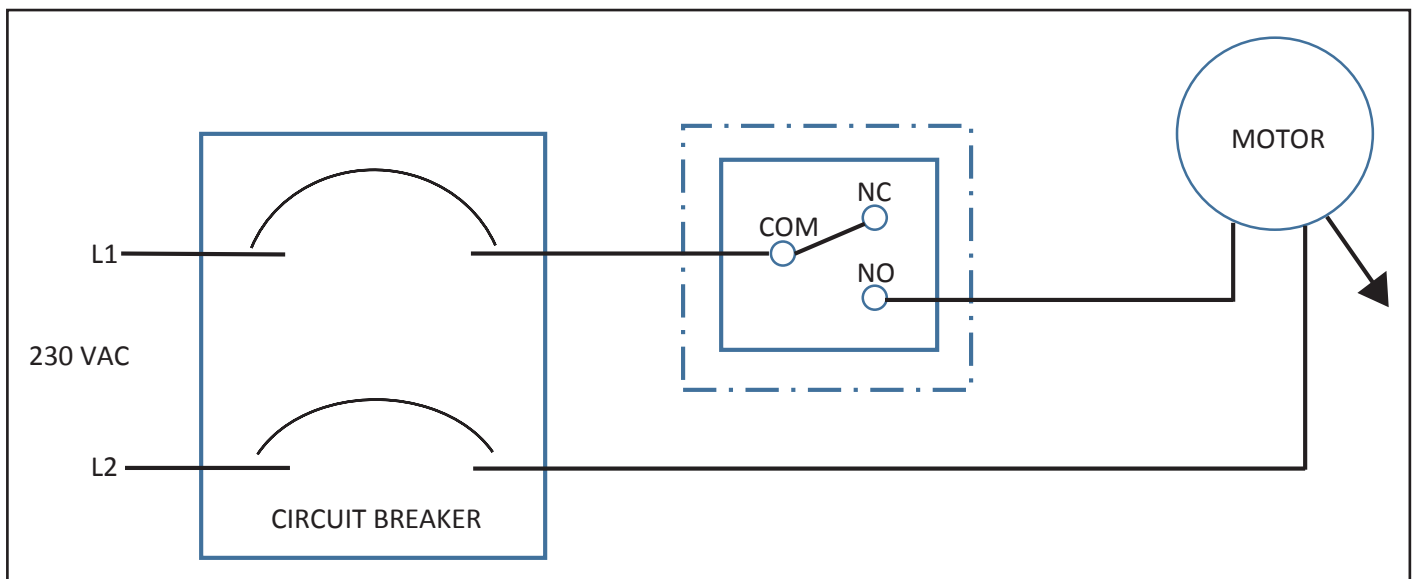

Boot Safety Switch Exploded Drawing

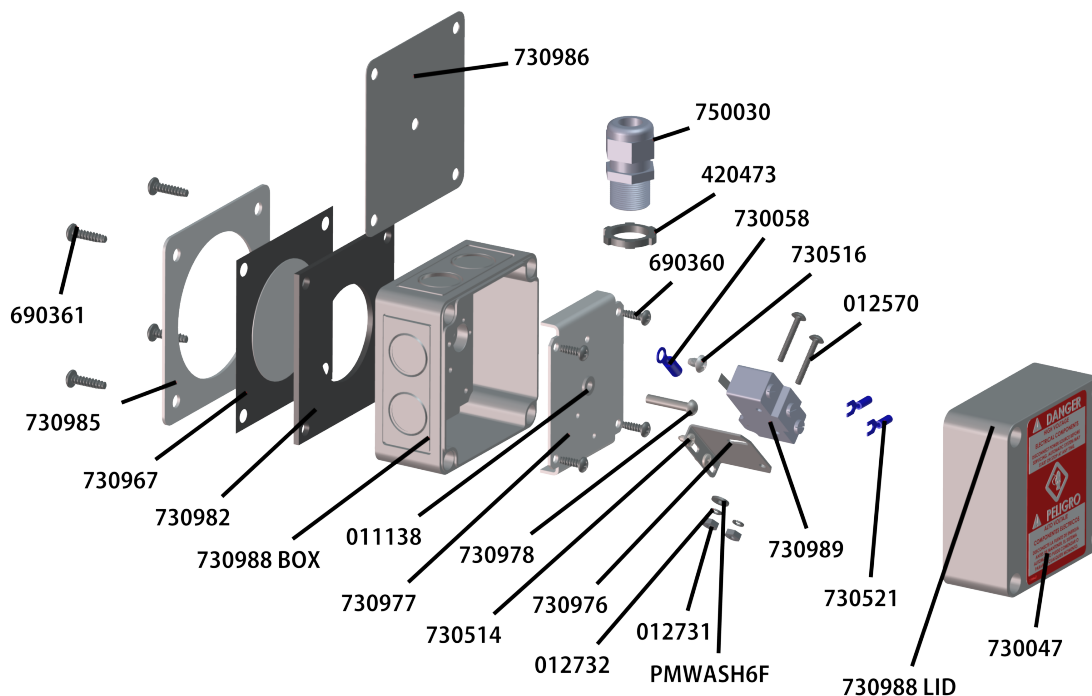

PART #	DESCRIPTION	QTY
730965		
011138	SPACER FLANGED .2ID .26OD .25L	1
012570	#6-32 X 1" RD HD MACHINE	2
012731	#6-32 MACHINE NUT	2
012732	#6 LOCKWASHER	2
420473	1/2" CONDUIT NUT	1
690360	SCREW, #8-16 X 1/2 PPH THRD FORM ZP,F/PLASTIC	4
690361	SCREW, #10-14 X 3/4 PPH THRD FORM ZP,F/PLASTIC	4
730047	HIGH VOLTAGE WARNING LABEL	1
730058	#16-14 RING TERMINAL	1
730514	SCREW, 6-32 X 1/4 PPH TRS ZP	2
730516	SCREW, 10-32 X 1/4 PPH TRS ZP	1
730521	TERMINAL, SPADE, 16-14AWG, #6	2
730967	DIAPHRAGM ASSY, 2.5"	1
730976	BRKT, SAFETY SWITCH	1
730977	BASE PLATE, SAFETY SWITCH	1
730978	RIVET, DOMED HD 3/16 OD X 1.0" SOLID, SS	1
730982	NEOPRENE SEAL, SAFETY SWITCH	1
730985	DIAPHRAGM RETAINER, SWITCH	1
730986	TEMPLATE, SAFETY SWITCH	1
730988	ELECTRIC BOX, BT SAFETY SWITCH	1
730989	MICRO SWITCH, SPDT 20A 250VAC	1
750030	STRAIGHT-THRU GROMMET	1
PMWASH6F	#6 FLAT WASHER	1

North America:

Phone: 800.99VALCO (800.998.2526)

Fax: 419.678.2200

Email: sales@val-co.com

U:\MANUALS\990000\990115

JDS 10-15-2014

© Valcompanies, Inc. 2014

International:

Phone: (+1) 419.678.8731

Fax: (+1) 419.678.2200

Email: intl.sales@val-co.com